

How fun that you've bought a PORTAL-shelf from TÔNÑ!
We hope that you'll get along well at home.

MOUNT YOUR SHELF

YOU'LL NEED:

Coffee and cake
Folding rule
Screwdriver
Screw L=60mm dk=5mm
(non countersunk)

Anchors/pins suited for your wall
Metal pins (enclosed)
Drilling machine
Carpenter's level
Pen

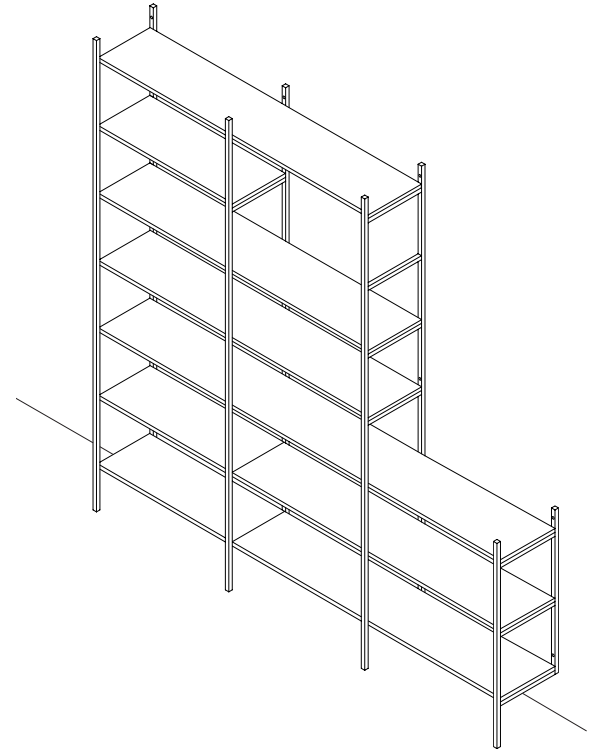
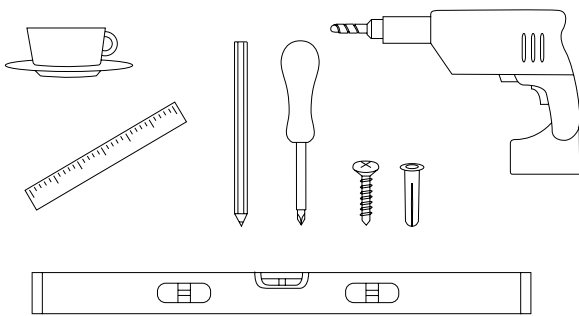

BEFORE MOUNTING - PLEASE NOTE:

We recommend a maximum distance of 80 cm between the ladders.
If you're using shelves from TÔNÑ you should have 80 or 45 cm (outer dimensions) between.

ABOUT THE SHELF EXTENDER:

Our longest shelf is 201 cm. If your shelving system is wider than that maybe you're using a shelf extender. If not - proceed to MOUNTING.

If you're using the shelf extender somewhere in the shelving system this should be mounted in a joint between two shelves on the underside. Since the joined shelves "share" a shelf ladder the shelves will protrude 1 cm on each side of the outermost shelf ladders (see scenario 2 below) or you'll move the ladders so that they end up in line with the shelves (see scenario 1 below).

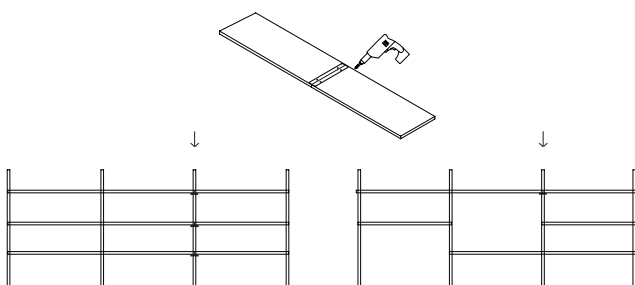

Scenario 1: Multiple shelf extenders with equally long shelves. The outermost shelf ladders is moved out 1 cm to get in line with the shelves.

Scenario 2: Single shelf extender. The shelves will protrude with 1 cm on each side of the ladders (Where the extender's been used).

MOUNTING

1. Mount the first shelf ladder where you want it. The shelf ladders should rest on one leg to not collide with the skirting board. Use a carpenter's level to make sure it is straight.
2. Lean the second shelf ladder against the wall, and click on shelves with the enclosed metal pins. One shelf high up and one low down. See below. (If your shelf has 123 or 158 cm shelves all through - mount the outermost ladders first so that they get in line with the shelves, then the middle one.) If you're using only 201 cm shelves we recommend mounting the first and second shelf ladder first, followed by number three and four.
3. Mark the holes in the second ladder. Take the loose parts down and drill.
4. When all shelf ladders are mounted - put all shelves on the ladders.
5. Start decorating.
6. Tap yourself on the shoulder, you're done! Enjoy coffee and some cake.

